

QRM14 series

Ø 14 mm rear panel mount LED indicators



DISTINCTIVE FEATURES

IP67 Sealed

Bi-Color & Tri-Color Options

2 to 28 VDC

200 mm wire terminations



ENVIRONMENTAL SPECIFICATIONS

- IP67 sealing option (EN60529)
- Operating Temperature Range: -40 °C to +85 °C (-40 °F to +185 °F)
- Storage Temperature Range: -55 °C to +100 °C (-67 °F to +212 °F)



GENERAL SPECIFICATIONS

- Max Reverse Voltage: 5 V
- Viewing Angle: 60°
- Life Expectancy: 100,000 hours
- Max Panel Thickness: 3.5 mm
- Torque: 75 cNm (Ø 14 mm)



MATERIALS

- Body: Black plated brass or anodized aluminum
- Lock Washer: Spring steel
- Nut: Black plated brass
- Terminal Seal: Epoxy
- Panel Seal: Nitrile O-ring
- Wires: 22A WG - Approved to UL1007



MOUNTING

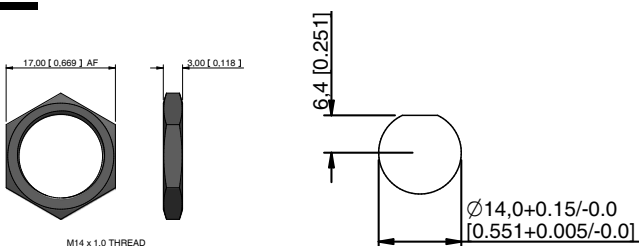

The company reserves the right to change specifications without notice.

LED characteristics are dependent upon environmental conditions. Therefore published data should be considered nominal and subject to variations.



QRM14 series

Ø 14 mm rear panel mount LED indicators



ELECTRICAL SPECIFICATIONS

STANDARD LED INTENSITY

LED COMPONENT SPECIFICATIONS		
	Flush	Forward Voltage
HE Red	10 mcd	2.0 V
Green	5 mcd	2.2 V
Yellow	4 mcd	2.1 V
Blue	100 mcd	3.3 V
White	150 mcd	3.3 V
Orange	200 mcd	2.2 V
Bi-color (Typical) (Red/Green)	14/10 mcd	2.0 V/2.2 V
Tri-color (Typical) (Red/Green/Yellow)	15/10/30 mcd	2.0 V/2.2 V/2.1 V

Bi-color - The color is changed by reversing the polarity of the supply voltage.
Tri-color - The indicator has red and green LEDs, when both connected yellow is produced.

SUPER BRIGHT LED INTENSITY

LED COMPONENT SPECIFICATIONS		
	Flush	Forward Voltage
HE Red	2,000 mcd	2.2 V
Green	680 mcd	3.5 V
Yellow	350 mcd	2.3 V
Blue	250 mcd	3.3 V
White	250 mcd	3.3 V
Orange	300 mcd	2.1 V

HYPER BRIGHT LED INTENSITY

LED COMPONENT SPECIFICATIONS		
	Flush	Forward Voltage
HE Red	800 mcd	2.0 V
Green	250 mcd	3.2 V
Yellow	250 mcd	2.0 V
Orange	200 mcd	2.1 V

- The operating voltage must not be exceeded by more than 10% as this will result in reduced life expectancy
- Luminous intensity is measured at 20 mA on a discrete led unless otherwise stated.
- Luminous intensities and color shades of white LEDs may vary within a batch.
- Luminous intensity will be reduced with lower operating current.

Voltage	Operating Voltage	Operating Current
	(Min to Max)	(Typical All Types)
02 (No Resistor)	1.8 to 3.8 VDC	20 mA max
6 VDC	5.4 to 6.6 VDC	20 mA
12 VDC	10.8 to 13.2 VDC	20 mA
24 VDC	21.6 to 26.4 VDC	20 mA
28 VDC	25.2 to 30.8 VDC	20 mA

* Customer to supply resistor for desired operating current.

QRM14 series

Ø 14 mm rear panel mount LED indicators



BUILD YOUR PART NUMBER

QRM

SERIES

MOUNTING HOLE

14 Ø14 mm

TERMINALS

5 Wires

BEZEL FINISH

B	Black
AK	Anodized Dark Olive
AN	Anodized Black

TYPE OF ILLUMINATION

XX	Fixed Light
YY	Bi-color
ZZ	Tri-color

R	Red
G	Green
Y	Yellow
B	Blue
W	White
O	Orange
HR	Hyper Bright Red
HG	Hyper Bright Green

LED COLOR

HY	Hyper Bright Yellow	SW	Super Bright White
HO	Hyper Bright Orange	SO	Super Bright Orange
SR	Super Bright Red	RG	Red/Green
SG	Super Bright Green	RY	Red/Yellow
SY	Super Bright Yellow	GY	Green/Yellow
SB	Super Bright Blue	RYG	Red/Yellow/Green

VOLTAGE

02	no resistor*
06	6 VDC
12	12 VDC
24	24 VDC
28	28 VDC

* please refer to the forward voltage in electrical specifications

SEALING

E	IP67 (Standard)
----------	-----------------



ABOUT THIS SERIES

- !** **Notice:** please note that not all combinations of above numbers are available.
- Standard wire length is 200 mm, 24 AWG UL1061, red wire denotes Anode (+), black wire denotes Cathode (-) for other wire lengths consult APEM.
 - For LEDs with alternate voltages and multi-voltage options consult APEM.
 - Bi-color LEDs, by connecting the gold Faston (+) one color is produced, by reversing the supply voltage another color is produced. Bi-color are available up to 28 VDC.
 - Take care when soldering (recommended solder temperature 300 °C - 3 sec).
 - The Tri-color LED has red and green LEDs when both are connected yellow is produced.
 - Standard Tri-color termination is two Anodes (+) and one Cathode (-).
 - Tri-color wires are one red (+) and one green (+) Anode and one black (-) Cathode.
 - Tri-color pins are center (-) Cathode, shortest (+) Anode pin green, longest (+) Anode pin red.

QRM14 series

Ø 14 mm rear panel mount LED indicators

REAR MOUNT - WIRES TERMINALS - SINGLE & BI-COLOR LED

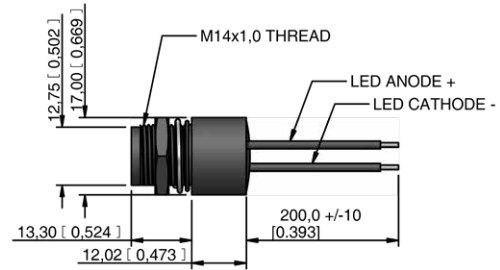

REAR MOUNT - WIRES TERMINALS - TRI-COLOR LED

