

DASH NO.	DESCRIPTION	MADE FROM
----------	-------------	-----------

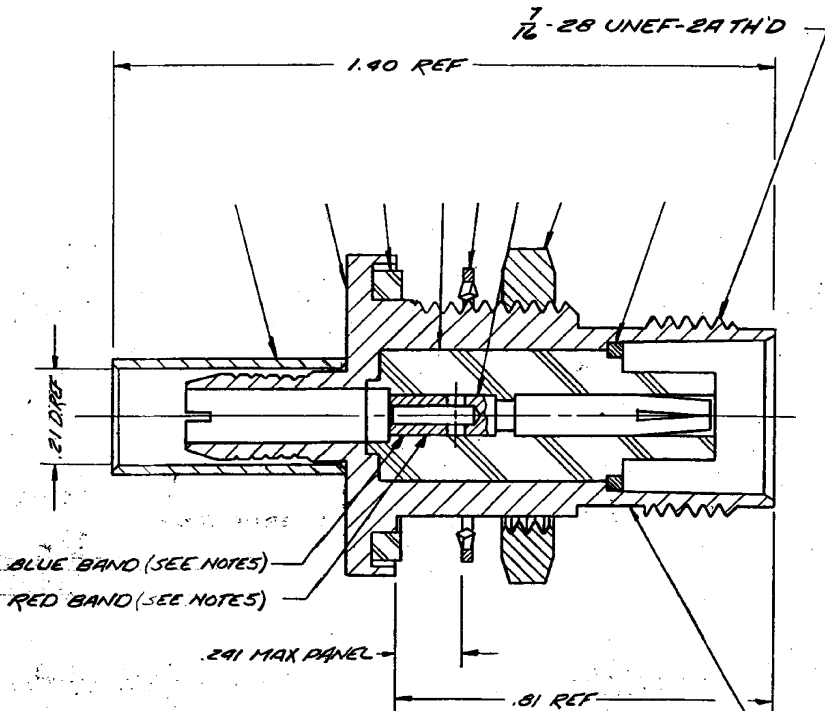

NOTES:

1. FOR USE WITH RG-58, 141 & 303/U CABLE.
2. FOR CABLE TRIMMING USE KTJ-113 & KTD-166.
3. FOR FORMING USE CRIMP DIE SIZE O1.
4. FOR CABLING INSTRUCTIONS SEE CP-465.
5. APPLY TWO BANDS, ONE BLUE & ONE RED, PER EO 25433.

STAMP: 91836 M39012/28-0504
KA-19-153 [XXXX]

DATE CODE

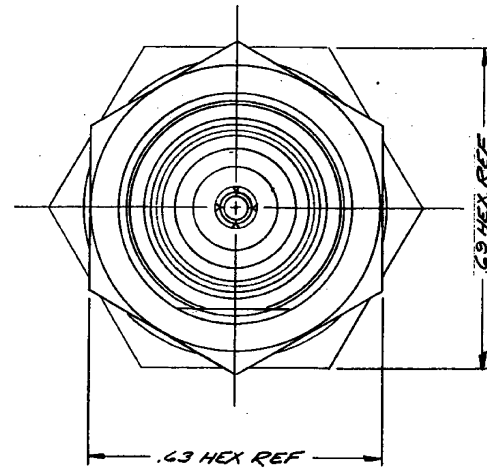
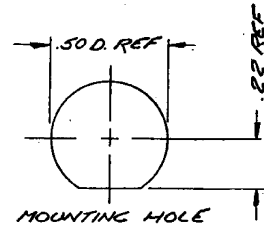

SD

M39012/28-0504

REVISIONS	
ISSUE	CHANGES
0	ER 16248 JHP 31 AUG 76
1	CN 21664 C PAS 23 FEB 81
2	CN 22767 E JEP 17 NOV 81
3	CN 25533 D MJB 15 DEC 83
4	CN 27833 A SD 3 MAR 86
5	CN 32302 A LNM 20 JUN 90

KA-19-153

USED ON:	
REF:	
FINISH	
SPEC. KER 10004	
MATL:	
SPEC.	
TNC BULKHEAD JACK	
DRAWN JHP	DATE 25 AUG 76
APPR. [Signature]	DATE 31 AUG 76

SD

KINGS ELECTRONICS
40 MARLBOROUGH ROAD
TUCKAHOE, N. Y. 10707

M39012/28-0504

UNLESS OTHERWISE SPECIFIED:

1. TOLERANCES: FRACTIONS & 2 PLACE DECIMALS ± .010
3 PLACE DECIMALS ± .004
7, 8, R. CONCENTRICITY OF ANY 2 DIAMETERS MAY NOT EXCEED HALF THE SUM OF THEIR TOLERANCES.
2. REMOVE ALL BURRS, BREAK SHARP EDGES .002 MAX.
3. NO FILLETS PERMITTED.
4. SURFACE ROUGHNESS 63 MICROINCHES RMS MAX.
5. ALL DIMENSIONS PRIOR TO PLATING.

ITEM	REQ'D	DESCRIPTION	PART NO.
------	-------	-------------	----------