

LTR	REVISION	DATE	APPD
D	103122-HF01: ADDED TERMINAL DIMENSIONS	11-01-22	HF

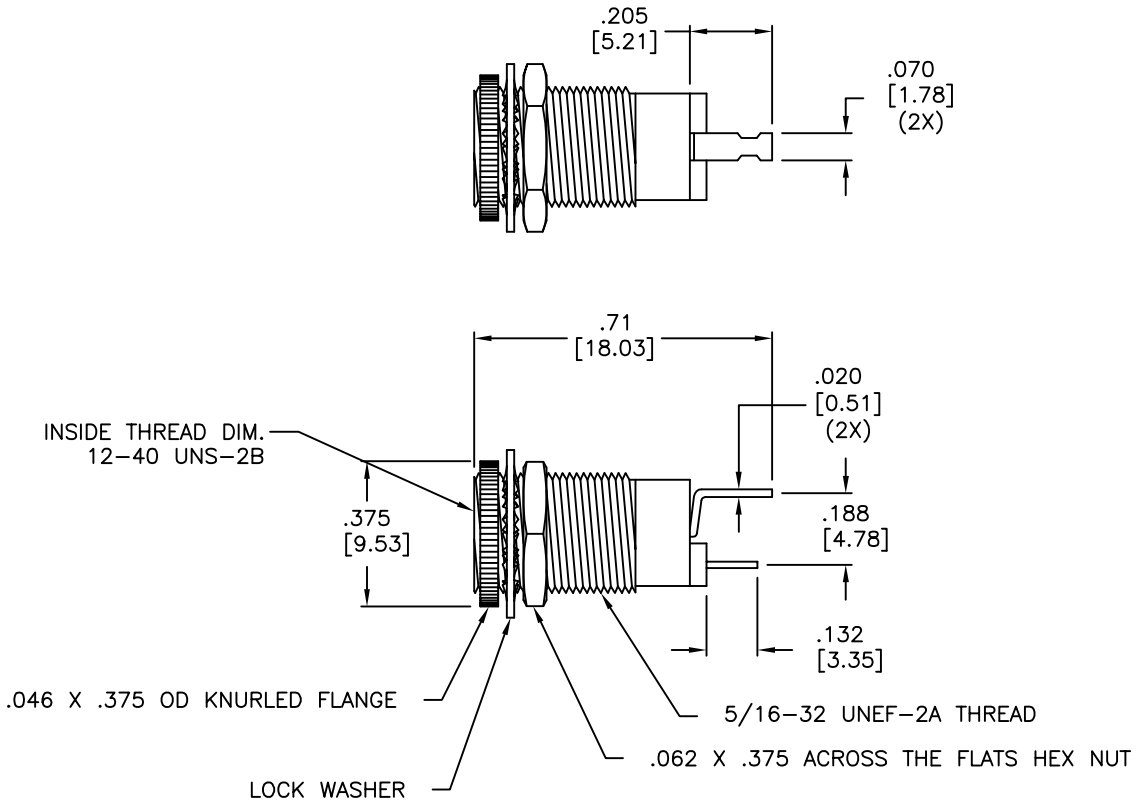

NOTES:

- ALL DIMENSIONS ARE IN INCHES [MILLIMETERS].
- MATERIAL: CASE - BRASS, NICKEL PLATED
MOUNTING HARDWARE - BRASS, NICKEL PLATED
TERMINALS - BRASS, GOLD PLATED
INSULATION - HIGH DIELECTRIC PLASTIC
- FINISH: HLD2010 - BRIGHT NICKEL
HLD2020 - BLACK NICKEL

REVISION NOTIFICATION	
<input type="checkbox"/>	DLC
<input type="checkbox"/>	UL/ETL
<input type="checkbox"/>	MADE IN USA
<input type="checkbox"/>	CUSTOMER _____
<input type="checkbox"/>	OTHER
REDLINE CHECKLIST	
<input type="checkbox"/>	REDLINE(YES)
<input type="checkbox"/>	DATE: _____
<input type="checkbox"/>	INITIATED BY: _____
<input type="checkbox"/>	ECR REQUIRED YES <input type="checkbox"/> NO <input type="checkbox"/>
<input type="checkbox"/>	WORK ORDER# _____

LED[®]
LEDTRONICS,™ INC.
23105 KASHIWA COURT
TORRANCE, CA 90505

-PROPRIETARY-
This document contains Proprietary
Information of LEDTRONICS, INC.
It may not be copied, used or disclosed
for any purpose without the prior express
written consent of LEDTRONICS, INC.

.XXX ± .010 TOLERANCE PER ANSI-Y14.5
.XX ± .025 (UNLESS OTHERWISE STATED)
ANGLES ± 0°,30'
FRACT. ± 1/32

TITLE HLD2010, HLD2020 (ADJUSTABLE)						
DWG NO	SCALE	SHEET	DATE			
CMHD0029	2:1	1 OF 1	10-07-96			
CODE IDENT NO.	DWG BY	CHK BY	QA	MFG	R&D	
8Z410	MRM		LUV	LD	UF	
	10-07-96		11-04-22	11-04-22	11-04-22	