

Solar system - RAD-SOL-SET-24-100-US - 5605943

Please be informed that the data shown in this PDF Document is generated from our Online Catalog. Please find the complete data in the user's documentation. Our General Terms of Use for Downloads are valid (<http://phoenixcontact.com/download>)



Complete solar system, consisting of solar panel and control cabinet with charge controller, solar battery, surge protection, fuses and mounting material.

Product Features

- Optional wall or mast mounting
- Prewired control cabinet including charge controller, solar battery, surge protection, and fuses

Key Commercial Data

Packing unit	1 pc
Weight per Piece (excluding packing)	116000.0 g
Custom tariff number	85013100
Country of origin	Germany

Technical data

Note

Trade restriction	The products are offered exclusively for export outside the EU and the European Economic Area.
-------------------	--

Dimensions

Width	489 mm
Height	822.4 mm
Depth	337.7 mm

Ambient conditions

Ambient temperature (operation)	-30 °C ... 60 °C
Ambient temperature (storage/transport)	-30 °C ... 60 °C

Control cabinet / System

System voltage	24 V DC
Max. load	2.4 W ... 12 W
Width	489 mm
Height	822.4 mm

Solar system - RAD-SOL-SET-24-100-US - 5605943

Technical data

Control cabinet / System

Depth	337.7 mm
Wind velocity	25 m/s (per m ² corresponds to wind load zone 2, at a force of 0.39 kN)
Snow load	0.85 kN (per m ² corresponds to snow load zone 2)

Charge controller

System voltage	24 V DC
Current consumption	< 8 mA
Nominal load	10 A
Short-circuit current	12.5 A
Solar input voltage	< 60 V
Solar input current	10 A
Temperature compensation	-60 mV/K
Acid gel battery	28.2 V DC
Disconnecting load	23 V DC
Connecting load	25.2 V DC

Solar panel

Voltage	typ. 18.1 V DC (voltage at maximum output)
Short-circuit current	≤ 2.95 A
Nominal capacity	≥ 50 Wp
Current	2.75 A (Current at maximum output)
Width	680 mm
Height	572 mm
Depth	34 mm

Solar battery

Nom. voltage	12 V DC
Nominal capacity	100 Ah
Width	168 mm
Height	213 mm
Depth	306 mm
Net weight	32 kg

Solar system - RAD-SOL-SET-24-100-US - 5605943

Articles in set

Solar battery - RAD-SOL-BAT-12-100 - 2885498



12 V/100 Ah gel solar battery, designed for use in the 200 Wp RAD-SOL-SET-24-200 solar system. Two batteries are required to operate the solar system.

Charge controller - RAD-SOL-CHG-24- 10 - 2885443



Fully automatic charge controller with electronic protection functions, for photovoltaic systems with a system voltage of 24 V.

Solar module - RAD-SOL-PAN-12- 50 - 2885456



12 V/50 Wp solar module, designed for use in the RAD-SOL-SET-24-100 or RAD-SOL-SET-24-200 solar system. Two or four modules are required to operate the solar system.

Control cabinet - RAD-SOL-BOX-24V - 2917353



Pre-wired aluminum cabinet for use outdoors, with charger, surge protection and fuses. Designed for use in the solar set RAD-SOL-SET-24-...

Solar panel bracket - RAD-SOL-MKT-100 - 2917735



Solar panel bracket for mounting 2 x RAD-SOL-PAN-12-50 solar panels on the wall or on a mast

Solar system - RAD-SOL-SET-24-100-US - 5605943

Classifications

eCl@ss

eCl@ss 4.0	27060805
eCl@ss 4.1	27060805
eCl@ss 5.0	27061805
eCl@ss 5.1	27061805
eCl@ss 6.0	27061805
eCl@ss 7.0	27061805
eCl@ss 8.0	27061802

ETIM

ETIM 2.0	EC000019
ETIM 3.0	EC000019
ETIM 4.0	EC000019
ETIM 5.0	EC000019

UNSPSC

UNSPSC 6.01	26121608
UNSPSC 7.0901	26121608
UNSPSC 11	26121608
UNSPSC 12.01	26121608
UNSPSC 13.2	26121608

Drawings

Solar system - RAD-SOL-SET-24-100-US - 5605943

Schematic diagram

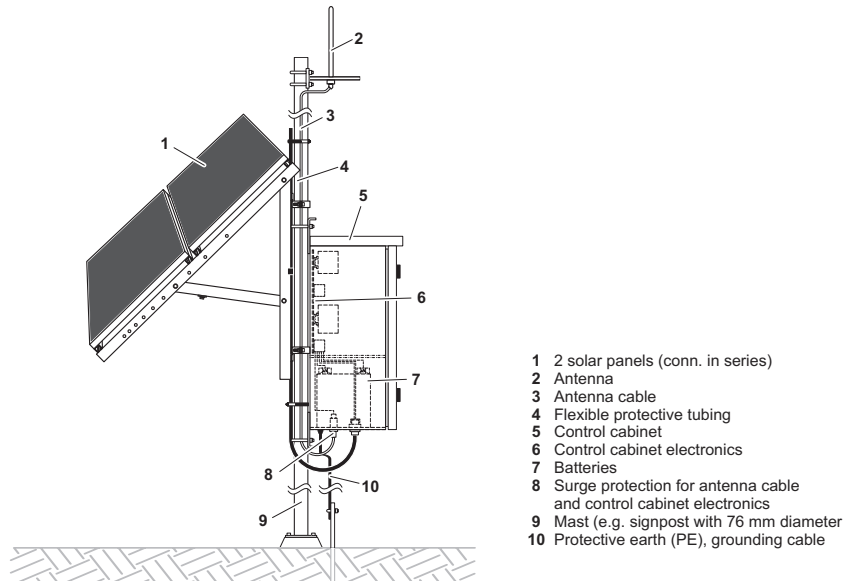

Example for a typical assembly of a solar system