

Housing - HC-ADV-B24-HHWH-1TGM40-PL - 1404238

Please be informed that the data shown in this PDF Document is generated from our Online Catalog. Please find the complete data in the user's documentation. Our General Terms of Use for Downloads are valid (<http://phoenixcontact.com/download>)



HEAVYCON ADVANCE B24 sleeve housing, with screw locking (Allen screw), plastic, height: 100 mm, with 1 x M40 thread, straight cable outlet

Why buy this product

- Integrated screw connection
- Lower costs than metal version
- Can also be used without panel mounting base
- Labeling option using 9 x 20 mm marking label
- Low weight
- Lower risk of condensation
- Both contact insert PE sheets are connected by means of a metal frame integrated in the sleeve housing
- Capacitive PE, even when connected at an angle
- Completely corrosion-resistant
- Halogen-free plastic
- Impact test according to IK 08

Key Commercial Data

| | |
|--------------|---|
| Packing unit | 1 STK |
| GTIN |  4 046356 682084 |

Technical data

Dimensions

| | |
|-------------------------------|-----------------|
| Height | 95 mm |
| Width | 57 mm |
| Length | 152 mm |
| Wrench size, union nut | 36 mm |
| External cable diameter | 19 mm ... 28 mm |
| Length of the assembly cutout | 112 mm |
| Width of the assembly cutout | 35 mm |

Ambient conditions

| | |
|--------------------------------------|------|
| Degree of protection of housing (IP) | IP66 |
|--------------------------------------|------|

Housing - HC-ADV-B24-HHWH-1TGM40-PL - 1404238

Technical data

Ambient conditions

| | |
|--|-----------------------|
| | IP68 (0.2 bar/24 h) |
| Degree of protection of housing (NEMA) | 4 (UL50e / NEMA 250) |
| | 4X (UL50e / NEMA 250) |
| | 6P (UL50e / NEMA 250) |
| | 12 (UL50e / NEMA 250) |
| Ambient temperature (operation) | -40 °C ... 100 °C |

General

| | |
|--|--|
| Note | For contact inserts HC-B24, BB46, D64, DD108, M, K, HV10-I-PT, HV 10-E...C |
| Size | B24 |
| Housing type | Sleeve housing |
| Color | black |
| Locking type | Screw locking |
| Torque | 3 Nm (Locking screw) |
| Fixing screws | M6 (screw head: 5 mm Allen screw) |
| No. of cable outlets | 1 |
| Cable exit | straight |
| Screw connection | with |
| Type of the screw connection | 1x M40 |
| Housing material | Polyamide |
| Seal material | NBR |
| Cable seal material | NBR |
| Material lock | Stainless steel |
| Material of locking screw | High-grade steel |
| Flammability rating according to UL 94 | V0 |
| Assembly instructions | M6 locking screw, with 5 mm Allen screw head |

Standards and Regulations

| | |
|--|----|
| Flammability rating according to UL 94 | V0 |
|--|----|

Classifications

eCl@ss

| | |
|------------|----------|
| eCl@ss 4.0 | 27140816 |
| eCl@ss 4.1 | 27140816 |
| eCl@ss 5.0 | 27143424 |
| eCl@ss 5.1 | 27143424 |
| eCl@ss 6.0 | 27143424 |
| eCl@ss 7.0 | 27440209 |
| eCl@ss 8.0 | 27440202 |
| eCl@ss 9.0 | 27440202 |

Housing - HC-ADV-B24-HHWH-1TGM40-PL - 1404238

Classifications

ETIM

| | |
|----------|----------|
| ETIM 3.0 | EC000516 |
| ETIM 4.0 | EC000437 |
| ETIM 5.0 | EC000437 |

UNSPSC

| | |
|---------------|----------|
| UNSPSC 6.01 | 31261502 |
| UNSPSC 7.0901 | 31261502 |
| UNSPSC 11 | 31261502 |
| UNSPSC 12.01 | 31261502 |
| UNSPSC 13.2 | 31261502 |

Approvals

Approvals

Approvals

EAC / GL

Ex Approvals

Approvals submitted

Approval details

| |
|-----|
| EAC |
|-----|

| |
|----|
| GL |
|----|

Drawings

Housing - HC-ADV-B24-HHWH-1TGM40-PL - 1404238

Dimensional drawing

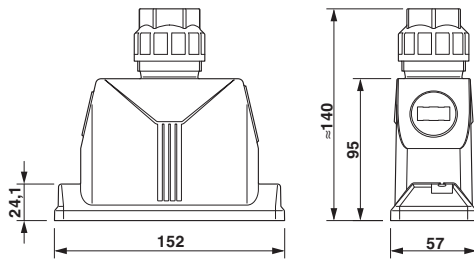

Dimensional drawing

Dimensional drawing

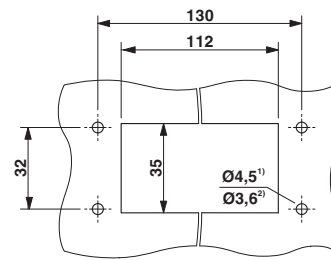

Mounting cutout

- 1) when a standard M4 screw is used
- 2) when self-tapping screws are used (Torx® 20, M4)

Phoenix Contact 2016 © - all rights reserved
<http://www.phoenixcontact.com>

PHOENIX CONTACT GmbH & Co. KG
Flachsmarktstr. 8
32825 Blomberg
Germany
Tel. +49 5235 300
Fax +49 5235 3 41200
<http://www.phoenixcontact.com>