

## Cable duct - CD 25X25 WH - 3240616

Please be informed that the data shown in this PDF Document is generated from our Online Catalog. Please find the complete data in the user's documentation. Our General Terms of Use for Downloads are valid (<http://phoenixcontact.com/download>)



Cable duct, white, comprising upper part and mounting base, width: 25 mm, height: 25 mm, length: 2000 mm

The figure shows the CD 80x80 WH version

### Why buy this product

- Easy, burr-free cutting with minimum effort using the CUTFOX-CD cable duct cutter
- Thanks to its leverage and special cutting geometry, the PPS CD cable duct cutter enables easy, burr-free cutting with minimum effort
- Predetermined breaking point enables tool-free, burr-free removal of bars
- The wide, diagonal heads of the cable duct bars make it easy to fit the cover and hold it securely in place
- Installed conductors are securely held in place by means of wire retaining clips that can be snapped onto bars on the side
- Plastic body-bound rivets enable easy fixing of cable ducts using the rivet setting tool

### Key Commercial Data

Packing unit	25 STK
Minimum order quantity	25 STK
GTIN	 4 046356 629126

### Technical data

#### Dimensions

Length (b)	2000 mm
Width (a)	25 mm
Height	25 mm

#### Ambient conditions

Ambient temperature (operation)	-5 °C ... 60 °C
---------------------------------	-----------------

#### General

Color	white
Components	Lead-free
Flammability rating according to UL 94	V0
Material	PVC

### Standards and Regulations

# Cable duct - CD 25X25 WH - 3240616

## Technical data

### Standards and Regulations

Halogen-free	no
Connection in acc. with standard	CSA
Flammability rating according to UL 94	V0

## Classifications

### eCl@ss

eCl@ss 4.0	27140602
eCl@ss 4.1	27140602
eCl@ss 5.0	27140602
eCl@ss 5.1	27140602
eCl@ss 6.0	27400703
eCl@ss 7.0	27400703
eCl@ss 8.0	27400703

### ETIM

ETIM 4.0	EC000012
ETIM 5.0	EC000012

### UNSPSC

UNSPSC 6.01	30101815
UNSPSC 7.0901	30101815
UNSPSC 11	30101815
UNSPSC 12.01	30101815
UNSPSC 13.2	30101815

## Approvals

### Approvals

---

#### Approvals

CSA / UL Recognized / VDE Zeichengenehmigung

---

#### Ex Approvals

---

#### Approvals submitted

---

#### Approval details

# Cable duct - CD 25X25 WH - 3240616

## Approvals

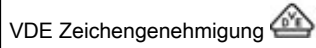
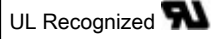

## Drawings

Dimensional drawing

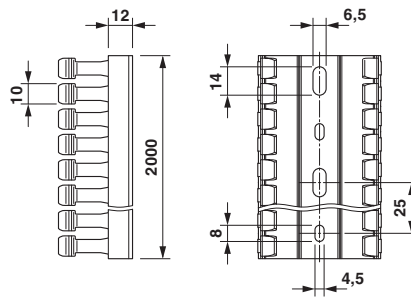

Base perforation according to DIN EN 50085

Phoenix Contact 2016 © - all rights reserved  
<http://www.phoenixcontact.com>

PHOENIX CONTACT GmbH & Co. KG  
Flachsmarktstr. 8  
32825 Blomberg  
Germany  
Tel. +49 5235 300  
Fax +49 5235 3 41200  
<http://www.phoenixcontact.com>