

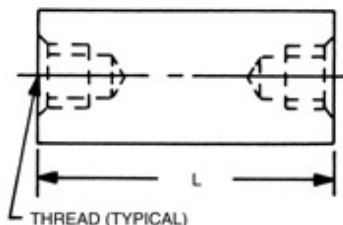

4.5mm HEX FEMALE STANDOFFS

RAF

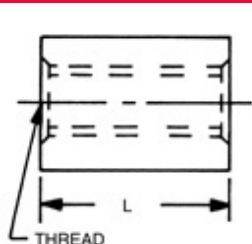

RAF

Order Code:

<<< >>> Contents

12-Zinc

Finishes:

Quote [\[How to create part numbers\]](#) [\[Material Specifications\]](#)

SELECT	PART NO.	LENGTH
<input type="checkbox"/>	M1250	3
<input type="checkbox"/>	M1251	4
<input type="checkbox"/>	M1252	5
<input type="checkbox"/>	M1253	6
<input type="checkbox"/>	M1254	7
<input type="checkbox"/>	M1255	8
<input type="checkbox"/>	M1256	9
<input type="checkbox"/>	M1257	10
<input type="checkbox"/>	M1258	11
<input type="checkbox"/>	M1259	12
<input type="checkbox"/>	M1260	13
<input type="checkbox"/>	M1261	14
<input type="checkbox"/>	M1262	15
<input type="checkbox"/>	M1263	16
<input type="checkbox"/>	M1264	17
<input type="checkbox"/>	M1265	18

SELECT	PART NO.	LENGTH
<input type="checkbox"/>	M1266	19
<input type="checkbox"/>	M1267	20
<input type="checkbox"/>	M1268	21
<input type="checkbox"/>	M1269	22
<input type="checkbox"/>	M1270	23
<input type="checkbox"/>	M1271	24
<input type="checkbox"/>	M1272	25
<input type="checkbox"/>	M1273	28
<input type="checkbox"/>	M1274	31
<input type="checkbox"/>	M1275	34
<input type="checkbox"/>	M1276	37
<input type="checkbox"/>	M1277	40
<input type="checkbox"/>	M1278	43
<input type="checkbox"/>	M1279	46
<input type="checkbox"/>	M1280	49
<input type="checkbox"/>	M1281	52

Select	CODE	THREAD
<input type="checkbox"/>	2545	M2.5x0.45
<input type="checkbox"/>	3005	M3x0.5

Select	CODE	MATERIAL	RoHS
<input type="checkbox"/>	AL	ALUMINUM	YES
<input type="checkbox"/>	B	BRASS	YES
<input type="checkbox"/>	SS	STAINLESS STEEL	YES
<input type="checkbox"/>	S	STEEL	YES
<input type="checkbox"/>	N	NYLON	YES

Ordering Code			
mxxxx	xxxx	xx	xx
Thread		Finish	
Length		Material	

For non standard items [please click here](#)

For thread depth information please click here



© 1999 RAF Electronic Hardware All Rights Reserved

Seymour CT 06483 203 888-2133 Fax: 203 888-9860 www.rafhdwe.com

