

PART NO. SEARCH - ENTER 3-4 CHARS:

ENTER

Catalogs: [ASE](#) | [Metric](#) | [Handles & Ferrules](#)[HOME](#)[PRODUCTS](#)[ONLINE CATALOG](#)[REQUEST QUOTE](#)[ORDER ONLINE](#)[CHECK STOCK](#)[REQUEST PRINT CATALOG](#)[REQUEST SAMPLES](#)[ENGINEERING DATA](#)[DISTRIBUTORS](#)[CAPABILITIES BROCHURE](#)**CALL NOW:
203 888-2133**Logos and links to MW
Industries, ECIA, and
NEFDA

13mm Hex Male-Female Standoffs

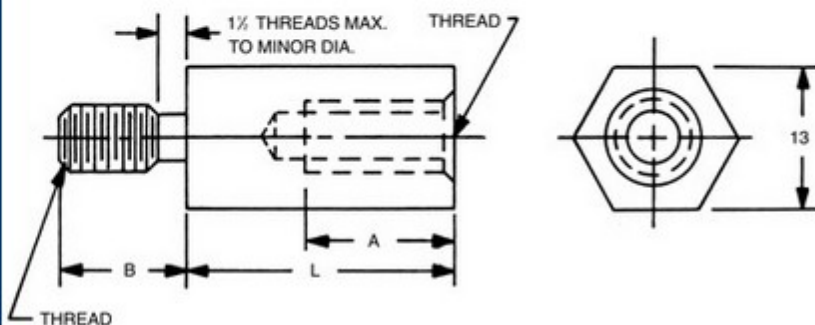

Select	Part No.	Length	Select	Part No.	Length
<input type="radio"/>	M2260	5	<input type="radio"/>	M2275	20
<input type="radio"/>	M2261	6	<input type="radio"/>	M2276	21
<input type="radio"/>	M2262	7	<input type="radio"/>	M2277	22
<input type="radio"/>	M2263	8	<input type="radio"/>	M2278	23
<input type="radio"/>	M2264	9	<input type="radio"/>	M2279	24
<input type="radio"/>	M2265	10	<input type="radio"/>	M2280	25
<input type="radio"/>	M2266	11	<input type="radio"/>	M2281	28
<input type="radio"/>	M2267	12	<input type="radio"/>	M2282	31
<input type="radio"/>	M2268	13	<input type="radio"/>	M2283	34
<input type="radio"/>	M2269	14	<input type="radio"/>	M2284	37
<input type="radio"/>	M2270	15	<input type="radio"/>	M2285	40
<input type="radio"/>	M2271	16	<input type="radio"/>	M2286	43
<input type="radio"/>	M2272	17	<input type="radio"/>	M2287	46
<input type="radio"/>	M2273	18	<input type="radio"/>	M2288	49
<input type="radio"/>	M2274	19	<input type="radio"/>	M2289	52

Thread Length Code					
Select	Code	Thread	A	B	
<input type="radio"/>	5008	M5x0.8	12.7	9.53	
<input type="radio"/>	6010	M6x1	15.0	12.7	
<input type="radio"/>	8012	M8x1.25	15.0	12.7	

Minimum Thread Depth 'A'
Body Length 'L'

Minimum Thread Depth 'A' & Body Length 'L'																			
Thread	L' 5	L' 6	L' 7	L' 8	L' 9	L' 10	L' 11	L' 12	L' 13	L' 14	L' 15	L' 16	L' 17	L' 18	L' 19	L' 20			
M5x0.8	.6	1.6	2.6	3.6	4.6	5.6	6.6	7.6	8.6	9.6	10.6	11.6	12.6						
M6x1			1.2	2.2	3.2	4.2	5.2	6.2	7.2	8.2	9.2	10.2	11.2	12.2	13.2				
M8x1.25				1.5	2.5	3.5	4.5	5.5	6.5	7.5	8.5	9.5	10.5	11.5	12.5	13.5			

[Home](#) [Previous](#) [Next](#)
[Related ASE](#)

Ordering Code			
M	XXXX	XXXX	XX
Length	Thread	Material	Finish

PART: M2277-5008-SS-20**Enter desired quantities:**

Qty 1

Qty 2

Qty 3

[Request Quote](#)[Check Stock](#)[Request Drawing](#)

Select	Code	Material	RoHS
<input type="radio"/>	AL	Aluminum	YES
<input type="radio"/>	B	Brass	YES
<input type="radio"/>	SS	Stainless Steel	YES
<input type="radio"/>	S	Steel	YES
<input type="radio"/>	N	Nylon	YES

[Material Specifications](#)

SELECT FINISH:

20-Passivation

* Finishes ending with an asterisk
are not RoHS Compliant[Ordering non-standard items](#)